

1	REVISION
2	DESCRIPTION
3	
4	
5	
6	
7	
8	

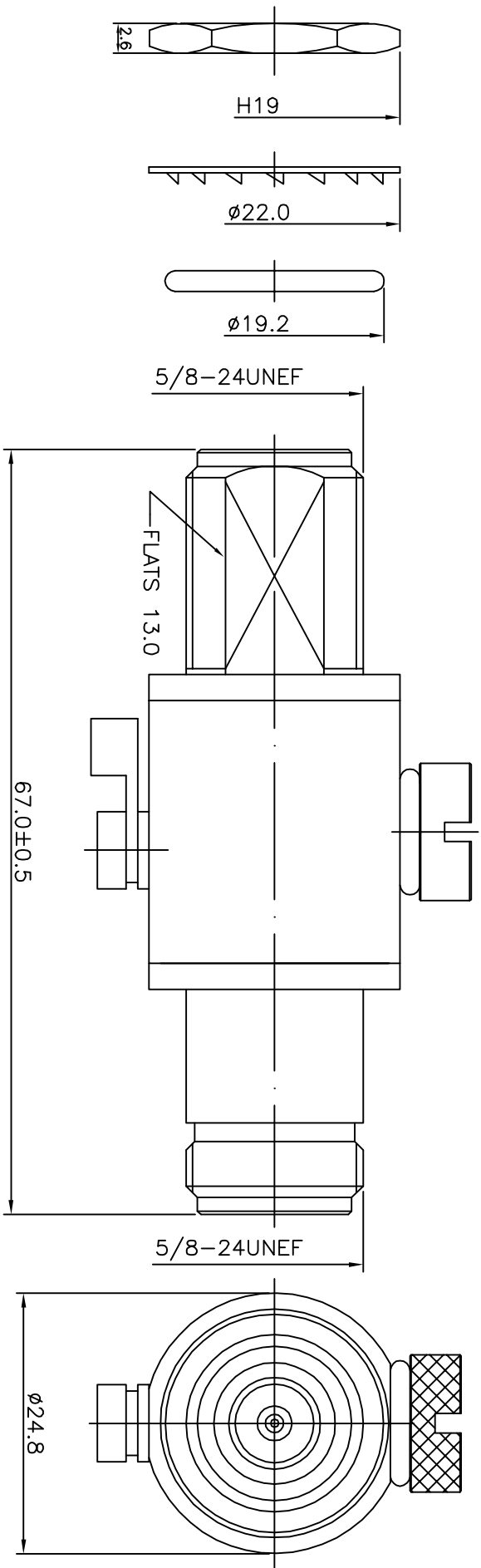

NOTE:
 1. Impedance: 50Ω
 2. Frequency Range : DC~6 GHz
 3. V.S.W.R. : ≤ 1.5
 4. Gas Tube DC Spark Over Voltage : 230V
 5. Gas Tube Impulse Discharge Current (Wave 8/20 us)
 10 Times (5 Times Each Polarity) : 10KA

TOLERANCES
 DIMENSIONS ARE IN MILLIMETER

UNLESS OTHERWISE SPECIFIED

.X ±0.2
 .XX ±0.1
 .XXX ±0.05
 ANGLES ±5°

NO.	DESCRIPTION	MATERIAL	FINISH	Q'TY	DRAWN NO.
18	SLEEVE	SUS 304	NONE	1	M-0374
17	BODY	BRASS	NICKEL	1	B-0699
16	NUT	BRASS	NICKEL	1	M-0248
15	WASHER	BRASS	NICKEL	1	M-0329
14	WASHER	BRASS	NICKEL	1	M-0330
13	BODY	BRASS	NICKEL	1	B-0772
12	PIN	BRASS	GOLD	1	C-0573
11	GAS TUBE	NONE	NONE	1	O-0089
10	O-RING	SILICONE	NICKEL	1	R-0032
9	SLEEVE	BRASS	NICKEL	1	E-0048
8	NUT	BRASS	NICKEL	1	D-0066
7	GASKET	RUBBER	NONE	2	R-0033
6	INSULATOR	TEFLON	NONE	2	T-0403
5	PIN	BRASS	GOLD	1	C-0571
4	BODY	BRASS	NICKEL	1	B-0700
3	GASKET	RUBBER	NONE	1	R-0006
2	WASHER	BRASS	NICKEL	1	G-0005
1	NUT	BRASS	NICKEL	1	D-0005

SCALE	2/1	ISSUE	A-0	FILE PATH:
4				
5				
6				
7				
8				

TITLE
 N JACK BULKHEAD TO N JACK
 LIGHTNING PROTECTOR

PART NO.
 95-38-1-50

DRAWN NO.
 95-0043

APPROVED
 DATE

CHECKED
 DATE

DRAWN
 DATE



A

B

C

D

E

F

A

B

C

D

E

F

1

2

3

4

5

6

7

8

9

10

11

12

13

14

15

16

17

18

19

20

21

22

23

24

25

26

27

28

29

30

31

32

33

34

35

36

37

38

39

40

41

42

43

44

45

46

47

48

49

50

51

52

53

54